

PRESS AUTOMATION

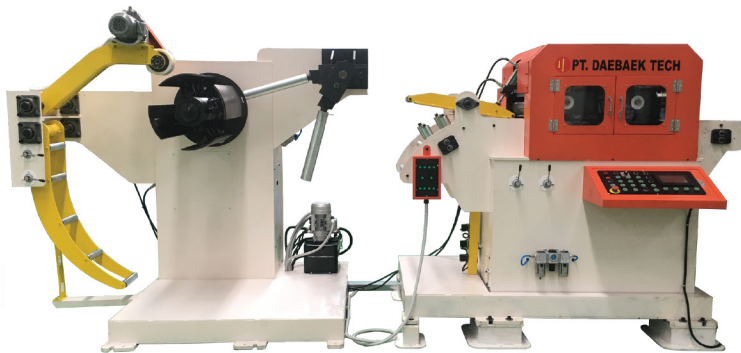

NC LEVeller FEEDER



UNCOILER

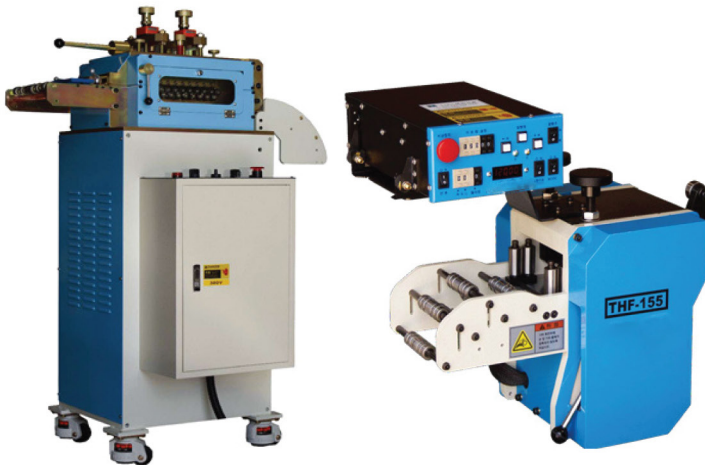

NC ROLL FEEDER



UNIT LEVeller



UNCOILER LEVeller



PALLET UNCOILER

Manufactured by :



Jl. Beringin No.9, Cibatu, Cikarang Selatan,
Kabupaten Bekasi, Jawa Barat 17530- Indonesia

More Information :



newproject03@daebaek.co.id



021 2918 5124



www.ptdaebaek.com

NC LEVELLER FEEDER



STRAIGHTENER FEEDER

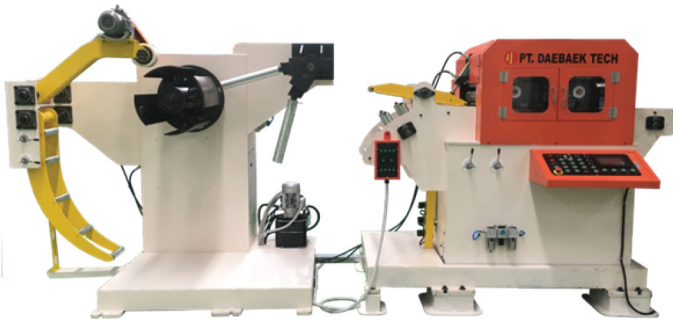

Option

- Coil car
- Coil Cotting Device
- Press Master
- Pad Band
- Insert Device

- **Space utilization**

All-in-one UNCOILER, LEVELLER, FEEDER increase space utilization and work efficiency.

- **Accurate transfer, high torque, high inertia**

Precise transfer realized by AC SERVO MOTOR and dedicated controller.

- **Diversity**

Various models are available depending on the thickness and width of the coil. (0.3 ~ 10mm in thickness)

- **High rigidity structure**

Integral block structure with LINK-type releasing structure provides quiet releasing and extended machine life.

- **Improved work ability**

Worker-centered machine structure and control system improve productivity and safety of workers by improving the working environment and minimizing work setting time.

Manufactured by :



Jl. Beringin No.9, Cibatu, Cikarang Selatan,
Kabupaten Bekasi, Jawa Barat 17530- Indonesia

More Information :



newproject03@daebaek.co.id



021 2918 5124



www.ptdaebaek.com

STRAIGHTENER FEEDER

SPECIFICATION

S' series

| Model | TNCL-3032 | TNCL-4032 | TNCL-5032 | TNCL-6032 | TNCL-7032 |
|-------------------------------------|-----------------------|-----------------------|------------------------|------------------------|------------------------|
| Material Width (mm) | 50 ~ 300 | 50 ~ 400 | 50 ~ 500 | 50 ~ 600 | 50 ~ 700 |
| Thickness (mm) | 0.5 ~ 3.2 | | | | |
| Material Transfer Width / Thickness | 3.2 × 80 1.5 × 300 | 3.2 × 80 1.5 × 400 | 3.2 × 120 1.5 × 500 | 3.2 × 150 1.5 × 600 | 3.2 × 150 1.5 × 700 |
| Coil Outer Diameter (mm) Coil | Φ1200 | | | | |
| Inner Diameter (mm) Weight (kg) | Ø508 or less | | | | |
| | 2000 | 3000 | 3000 | 5000 | 5000 |
| Line speed (M/min) | 34 | | | | |
| Feeding Accuracy | ±5/100 | | | | |
| Work Roll Number | Upper 4 / Low 4 | | | | |
| Servo motor capacity (kw) | AC 3.5 ~ 5.0 | | | | |
| Power Supply | AC 220V 3Φ 50/60Hz | | | | |

M' series

| Model | TNCL-4042 | TNCL-5042 | TNCL-6042 | TNCL-7042 | TNCL-8042 |
|-------------------------------------|------------------------|------------------------|------------------------|------------------------|------------------------|
| Material Width (mm) | 50 ~ 400 | 50 ~ 500 | 50 ~ 600 | 50 ~ 700 | 50 ~ 800 |
| Thickness (mm) | 0.5 ~ 4.2 | | | | |
| Material Transfer Width / Thickness | 4.2 × 120 1.2 × 400 | 4.2 × 120 1.2 × 500 | 4.2 × 150 1.0 × 600 | 4.2 × 150 0.8 × 700 | 4.2 × 200 0.8 × 800 |
| Coil Outer Diameter (mm) Coil | 1200 이하 | | | | |
| Inner Diameter (mm) Weight (kg) | Ø508 or less | | | | |
| | 3000 | 3000 | 5000 | 5000 | 5000 |
| Line speed (M/min) | 22 | | | | |
| Feeding Accuracy | ±5/100 | | | | |
| Work Roll Number | Upper 4 / Low 4 | | | | |
| Servo motor capacity (kw) | AC 3.5 ~ 7 | | | | |
| Power Supply | AC 220V 3Φ 50/60Hz | | | | |

L' series

| Model | TNCL-2060 | TNCL-4060 | TNCL-5060 | TNCL-6060 | TNCL-7060 | TNCL-8060 |
|-------------------------------------|------------------------|------------------------|------------------------|------------------------|------------------------|------------------------|
| Material Width (mm) | 50 ~ 200 | 50 ~ 400 | 50 ~ 500 | 50 ~ 600 | 50 ~ 700 | 50 ~ 800 |
| Thickness (mm) | 0.8 ~ 6.0 | | | | | |
| Material Transfer Width / Thickness | 6.0 × 100 2.0 × 200 | 6.0 × 100 2.0 × 400 | 6.0 × 100 2.0 × 500 | 6.0 × 120 2.0 × 600 | 6.0 × 150 2.0 × 700 | 6.0 × 150 2.0 × 800 |
| Coil Outer Diameter (mm) Coil | Φ1500 | | | | | |
| Inner Diameter (mm) Weight (kg) | Ø508 or less | | | | | |
| | 4000 | 4000 | 5000 | 5000 | 7000 | 7000 |
| Line speed (M/min) | 20 | | | | | |
| Feeding Accuracy | ±5/100 | | | | | |
| Work Roll Number | Upper 4 / Low 4 | | | | | |
| Servo motor capacity (kw) | AC 5.0 ~ 11 | | | | | |
| Power Supply | AC 220V 3Φ 50/60Hz | | | | | |

• The appearance and specifications of all products are subject to change without notice for performance improvement

Manufactured by :



Jl. Beringin No.9, Cibatu, Cikarang Selatan,
Kabupaten Bekasi, Jawa Barat 17530- Indonesia

More Information :

 newproject03@daebaek.co.id

 021 2918 5124

 www.ptdaebaek.com

UNIT LEVELLER



ISO 14001:2015



ISO 9001:2015



245

- Model with precision leveling ability.
- Easy leveling control does not require skills. (Digital indicator)
- The speed can be adjusted freely with a continuously variable transmission. (Option)
- The **CONTROL** part is equipped with various functions to make it easy to use and comes with a function to prevent motor damage
- All products are standardized, so you can choose various models depending on the thickness of materials. (See SPECIFICATION)

Option

- Head Part Open Structure (Work Roll 30, 34, 50 Φ)
- Wheel
- Inverter Control

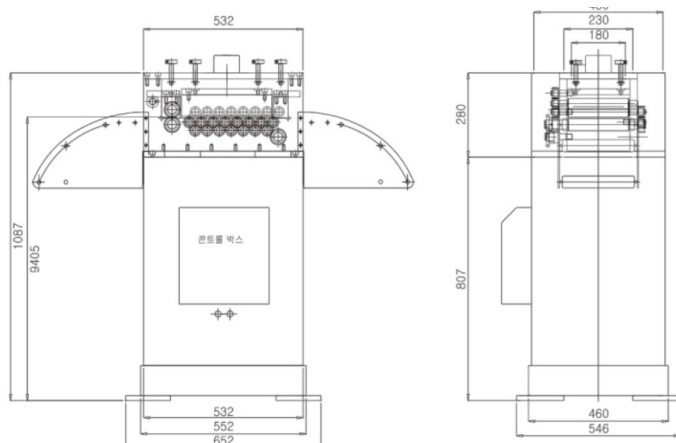

TL-20S



SPECIFICATION

| Spec Model | Coil Width (m/m) | Coil Thickness (m/m) | Work Roll Diameter (m/m) | Number of Work Rolls | Speed | Motor (kw*P) | Punch Roll Type |
|---------------|---------------------|------------------------------|--------------------------------|--|-------|-----------------|-----------------------------|
| TL-20S | 200 | 0.3 ~ 2.3 | Ø34 | Top 7+1 rolls (select roll), bottom 8 rolls | 5~25 | 0.75*4 | Manual |
| TL-30S | 300 | | | | | 1.5*4 | |
| TL-40S | 400 | | | | | | |
| TL-50S | 500 | | | | | | |
| TL-60S | 600 | | | | | | |
| TL-20 | 200 | 0.3 ~ 2.8 (0.5~3.2) | Ø40 Ø50 (Ø60) | Top 4+1 rolls, bottom 5 rolls (Top 3+1 rolls, bottom 4 rolls) Top 6+1 rolls, bottom 7 rolls | 5~25 | 0.75*4 | Manual (Air Cylinder) |
| TL-30 | 300 | | | | | 1.5*4 | |
| TL-40 | 400 | | | | | | |
| TL-50 | 500 | | | | | | |
| TL-60 | 600 | | | | | | |
| TL-70 | 700 | | | | | | |

• The appearance and specifications of all products are subject to change without notice for performance improvement

Manufactured by :



PT. DAE BAEK

Jl. Beringin No.9, Cibatu, Cikarang Selatan,
Kabupaten Bekasi, Jawa Barat 17530- Indonesia

More Information :



newproject03@daebaek.co.id



021 2918 5124



www.ptdaebaek.com

UCOILER LEVELLER



- Produced in consideration of solid mechanical structure and convenient work ability.
- Integration of uncoiler and leveller minimizes install at ion space.
- Various optional features improve the convenience of work.

Option

- Hydraulic Expansion & Reduction
- Inverter Control
- Coil Pusher
- Coil Car
- Uncoiler Drive
- Color

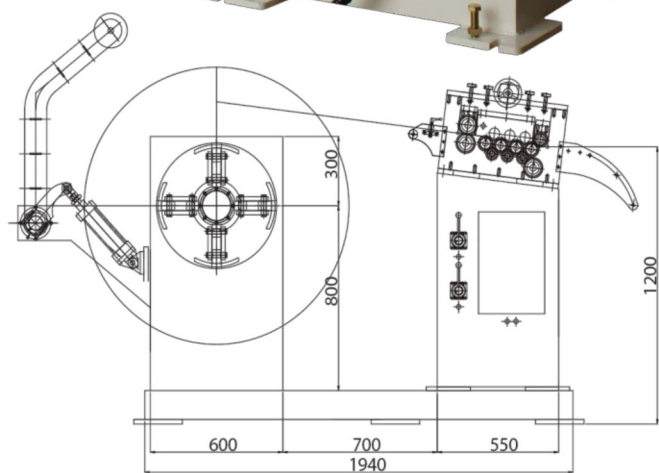
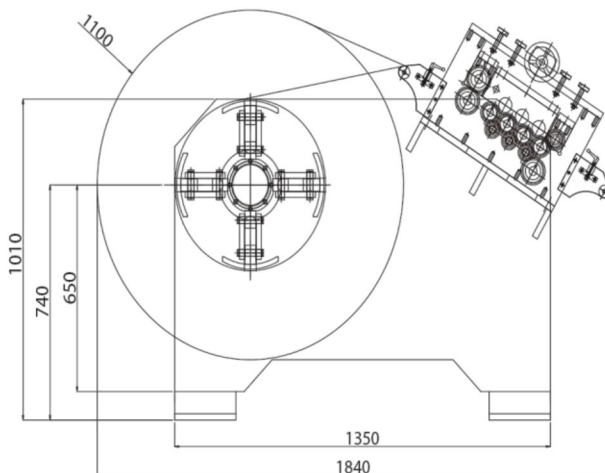

SPECIFICATION

| Spec Model | Coil Weight (mm) | Coil Width (mm) | Coil Thickness (mm) | Coil Inner Diameter (mm) | Coil Outer Diameter (mm) | Work Roll | Number of rotations | Workroll Specifications |
|---------------------|---------------------|--------------------|------------------------|-----------------------------|-----------------------------|---------------------------------|------------------------|---|
| TUL-20 (TULS-20) | 1000 | 200 | 0.5~3.2 | 508 | 1100 | Top 4+1 rolls bottom 5 rolls | 5~20 | 3 kinds 1.34Ø 2.40Ø 3.50Ø 4.60Ø |
| TUL-30 (TULS-30) | 2000 | 300 | | | 1200 | | | |
| TUL-40 (TULS-40) | 3000 | 400 | | | | | | |
| TUL-50 (TULS-50) | 3000 | 500 | | | | | | |
| TUL-60 | 4000 | 600 | | | 1500 | | 5~15 | (Will change depending on material thickness) |
| TUL-70 | 4000 | 700 | | | | | | |
| TUL-80 | 5000 | 800 | | | | | | |

- The appearance and specifications of all products are subject to change without notice for performance improvement

Manufactured by :



Jl. Beringin No.9, Cibatu, Cikarang Selatan,
Kabupaten Bekasi, Jawa Barat 17530- Indonesia

More Information :



newproject03@daebaek.co.id



021 2918 5124



www.ptdaebaek.com

SPEED NC ROLL FEEDER



ISO 14001:2015



ISO 9001:2015



245

Thickness: MAX 2.0mm, Width: MAX 2000mm (MAX 700mm), Speed : MAX 600spm

- Mechanism integrated structure
- High precision: 3/100
- Dedicated CPU: Improved control speed
- Stability: Double dustproof structure, perfect noise countermeasure
- Easy adjustment of roll gap and roll pressure
- Self-diagnostic protective function (Error code display)
- Releasing cam method
- Forward / Reverse drive switchable



Option

- Material end detection
- 2-stage pitch feed
- Urethane coating roll
- Feeder master
- Remote box
- Other specification

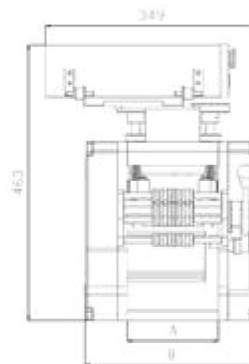

Front

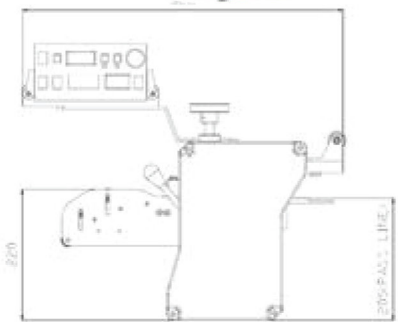

Right

Spec - dim

(Unit : mm)

| | THF-155 | THF-205 | THF-255 |
|---|---------|---------|---------|
| A | 150 | 200 | 250 |
| B | 284 | 334 | 384 |

| Model | THF-155 | THF-205 | THF-255 |
|-------------------------|-----------------|---------|---------|
| Material Width (mm) | MAX 100 | MAX 150 | MAX 200 |
| Material Thickness (mm) | MAX 2 | | |
| Max SPM (speed) Feeding | 600 | 480 | |
| Length (mm) Body Weight | MAX 999.99 | | |
| (kg) Releasing Method | 40 | 45 | 50 |
| Material Feeding | Cam(Mechanical) | | |
| Width/Thickness (W/mm) | 100/1 | 150/1 | 200/1 |
| | 60/2 | 100/1.6 | |

Products other than the above specifications can be customized.

- The appearance and specifications of all products are subject to change without notice for performance improvement

Manufactured by :



Jl. Beringin No.9, Cibatu, Cikarang Selatan,
Kabupaten Bekasi, Jawa Barat 17530- Indonesia

More Information :



newproject03@daebaek.co.id



021 2918 5124



www.ptdaebaek.com

NC ROLL FEEDER (TSF-100)

Thickness: MAX 2.0mm, Width: MAX 2000mm (MAX 700mm), Speed: MAX 600spm



ISO 14001:2015



ISO 9001:2015



245

- Machine body and control integrated type
- Digital switch to improve setting and operability
- Feed speed can be set arbitrarily by digital switch
- Release operating time can be set (100steps)
- Inching (Left / Right) feed amount display

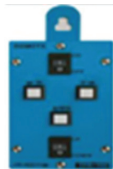

Option

- Material end detection
- Feeder master
- 2-stage pitch feed
- Remote box
- Urethane coating roll
- Other specification

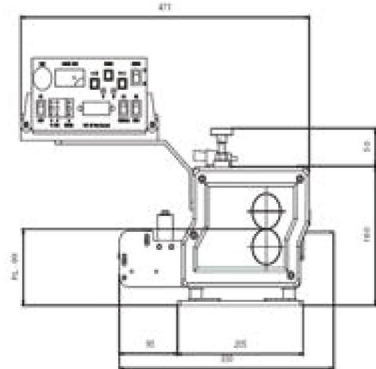
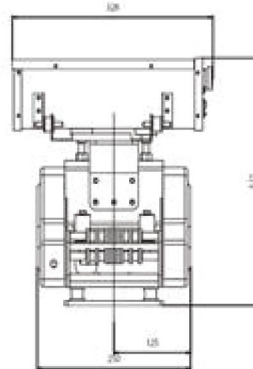

SPECIFICATION

| | |
|-----------------------------------|---|
| Maximum material width | 100 mm |
| Material Thickness | 1.0 mm |
| maximum transfer length | 999.99 mm |
| Body Weight | 20 kg |
| Material Pressing Method | Spring pressurization |
| | 90 kgf/m ³ |
| Releasing Method Release | Air Cylinder (special type) |
| Operating Time | 0.02 sec |
| Degree of Repeated Feeding | ±0.05mm |
| | No release when transfer length is 50mm |
| Material Transfer Width/Thickness | 100 x 0.2 |
| | Width (mm) * Thickness (mm) |
| Power Supply | 3相AC220V 50.60Hz |

| Model | TSF-100 | |
|----------------|----------|------|
| Transfer angle | 180° | 210° |
| Press rotation | Standard | |
| SPM | mm | |
| 300 | 12 | 17 |
| 260 | 17 | 24 |
| 220 | 25 | 36 |
| 200 | 31 | 45 |
| 180 | 40 | 56 |
| 160 | 52 | 73 |
| 140 | 70 | 97 |
| 120 | 97 | 136 |
| 100 | 144 | 200 |
| 80 | 231 | 318 |
| 60 | 408 | 528 |

- The appearance and specifications of all products are subject to change without notice for performance improvement

Manufactured by :



Jl. Beringin No.9, Cibatu, Cikarang Selatan,
Kabupaten Bekasi, Jawa Barat 17530- Indonesia

More Information :



newproject03@daebaek.co.id



021 2918 5124



www.ptdaebaek.com

UNCOILER



- Excellent durability
- Robust mechanical structure
- Smooth operation
- Easy operability

Option

- Hydraulic Expansion & Reduction
- Inverter Control
- Coil Pusher
- Double Uncoiler
- Coil Car

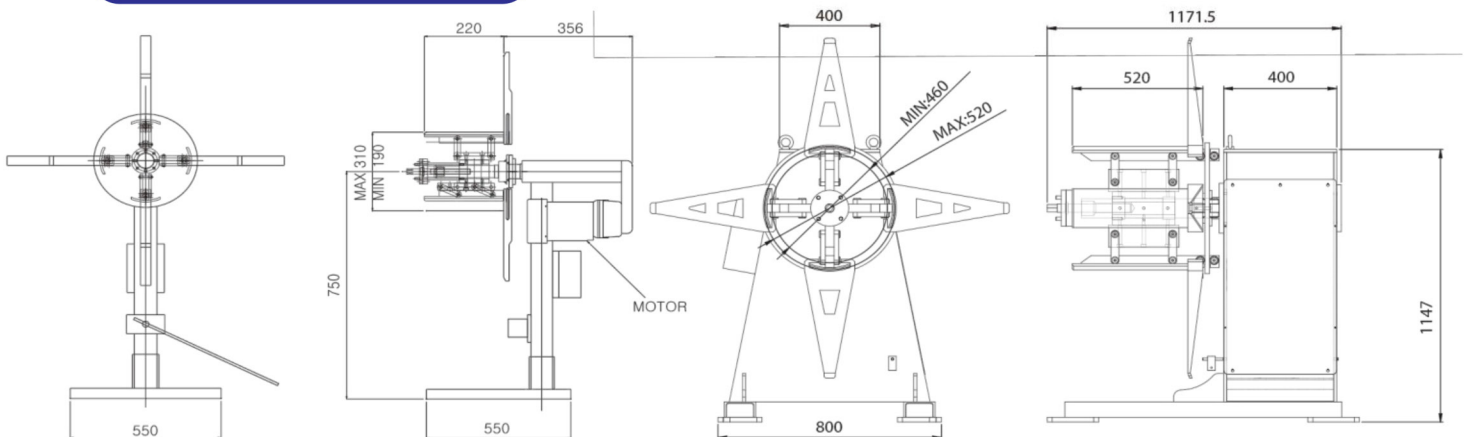

REEL STAND [TURS-15]

UNCOILER [TUCM-100]

SPECIFICATION

Option [Inverter(I),hydraulic expansion & reduction(H),Coil car(C),pusher(P)]

| Spec Model | Coil Weight (mm) | Coil Width (mm) | Coil Inner Diameter (mm) | Coil Outer Diameter (mm) | Number of revolutions (rpm) | Optional Items |
|------------|------------------|-----------------|--------------------------|--------------------------|-----------------------------|----------------|
| TURS-08 | 80 | 150 | 180~320 | 800 | 17 | |
| TURS-15 | 150 | 180 | 190~320 | 1000 | 13 | |
| TUCM-20 | 200 | 200 | 190~320 | 1000 | 13 | I |
| TUCM-30 | 300 | 250 | 300~420 | 1100 | 12 | I |
| TUCM-50 | 500 | 350 | 390~440 | 1200 | 12 | IP |
| TUCM-100 | 1000 | 500 | 460~520 | 1200 | 12 | IHP |
| TUCM-200 | 2000 | 500 | 460~520 | 1200 | 12 | IHCP |
| TUCM-300 | 3000 | 600 | 460~520 | 1200 | 10 | IHCP |
| TUCM-500 | 5000 | 700 | 470~520 | 1500 | 10 | IHCP |

- The appearance and specifications of all products are subject to change without notice for performance improvement

Manufactured by :



Jl. Beringin No.9, Cibatu, Cikarang Selatan,
Kabupaten Bekasi, Jawa Barat 17530- Indonesia

More Information :



newproject03@daebaek.co.id



021 2918 5124



www.ptdaebaek.com

NC ROLL FEEDER

Thickness : MAX 5.0mm, Width : MAX 700mm, Speed : MAX 130spm



- Mechanism integrated structure or mechanism separation type
- High precision: $\pm 5/100$
- Dedicated CPU: Improved control speed
- 100-step speed setting
- Equipped with high inertia motor of high torque
- Self-diagnostic protective function (Error code display)
- Perfect noise and dustproof measures (control)
- High rigid frame structure design

Option

- Material end detection
- Feeder master
- 2-stage pitch feed
- Remote box
- Urethane coating roll
- Other specifications
UP / DOWN device (electric)



SPECIFICATION

| Model | Material | TMF-2050 | TMF-3050 | TMF-4050 | TMF-5050 | TMF-6050 | TMF-7050 |
|------------------------|-------------------|--------------------|----------------|----------------|------------------|------------------|----------------|
| Width (mm) | Material | MAX 200 | MAX 300 | MAX 400 | MAX 500 | MAX 600 | MAX 700 |
| Thickness (mm) | Feeding | MAX 5.0 | | | | | |
| Length (mm) | Releasing | MAX 999.99(9999.9) | | | | | |
| Method | Material Transfer | AIR Cylinder | | | | | |
| Width/Thickness (W/mm) | | 200/2 120/5 | 300/2 150/5 | 400/2 150/5 | 500/1.5 250/5 | 600/1.2 200/5 | 700/1 200/5 |

- The appearance and specifications of all products are subject to change without notice for performance improvement

Manufactured by :



Jl. Beringin No.9, Cibatu, Cikarang Selatan,
Kabupaten Bekasi, Jawa Barat 17530- Indonesia

More Information :



newproject03@daebaek.co.id



021 2918 5124



www.ptdaebaek.com

PALLET UNCOILER



Horizontal Uncoiler Features:

- Feeding with relay, 0-30m per minute, adjustable speed.
- The coil material can be stacked, reducing feeding time.
- Easy to operate, steady structure. It will have a better performance with using high-speed punch.

Attention:

1. The outer diameter of the rolled material **cannot exceed the disc**, the maximum accumulation height is **450MM**, the maximum material thickness is **1.0MM**, the maximum material width is **130MM**, and the maximum feeding speed is **30M/MIN**.
2. The voltage of Induction type uses **three-phase 380V**, while the Electronic tracking type and the Frequency-controlled Speed type uses **three-phase 220V**.



SPECIFICATION

| | Inductive | Electronic | | | |
|-----------------------------------|---|---------------|---------------|---------------|---------------|
| | ZT-1000/1200 | ZT-1010 | ZT-1210 | ZT-1515 | ZT-1520 |
| Model | | | | | |
| Volume (Length, width, height) | 1.1*1.0*1.6m | 1.1*1.0*1.75m | 1.3*1.2*1.75m | 1.6*1.5*1.75m | 1.6*1.5*1.75m |
| Weight | 250 | 300 | 350 | 500 | 550 |
| Loading Height | 450 | 450 | 450 | 450 | 450 |
| Voltage | 380V | 220V/380V | 220V/380V | 220V/380V | 220V/380V |
| Disc diameter | 1000/1200 | 1000 | 1200 | 1500 | 1500 |
| Weight-bearing | 300kg | 500kg/1t | 1 t | 1 . 5t | 2t |
| Attention | <p>1. The outer diameter of the rolled material cannot exceed the disc, the maximum accumulation height is 450MM, the maximum material thickness is 1.0MM, the maximum material width is 130MM, and the maximum feeding speed is 30M/MIN .</p> <p>2. The voltage of Induction type uses three-phase 380V, while the Electronic type and the Frequency-controlled Speed type uses three-phase 220V.</p> | | | | |

- The appearance and specifications of all products are subject to change without notice for performance improvement

Manufactured by :



Jl. Beringin No.9, Cibatu, Cikarang Selatan,
Kabupaten Bekasi, Jawa Barat 17530- Indonesia

More Information :



newproject03@daebaek.co.id



021 2918 5124



www.ptdaebaek.com

OIL LUBRICANT

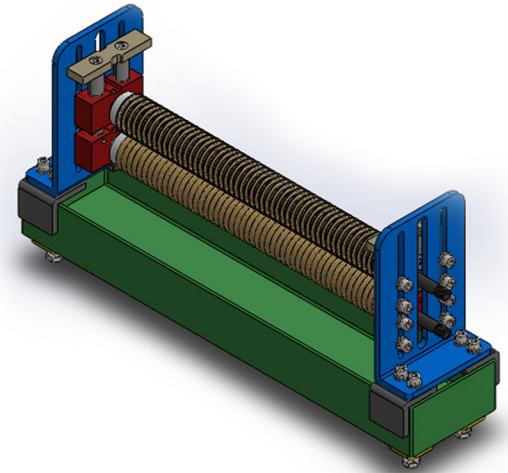

SPECIFICATION

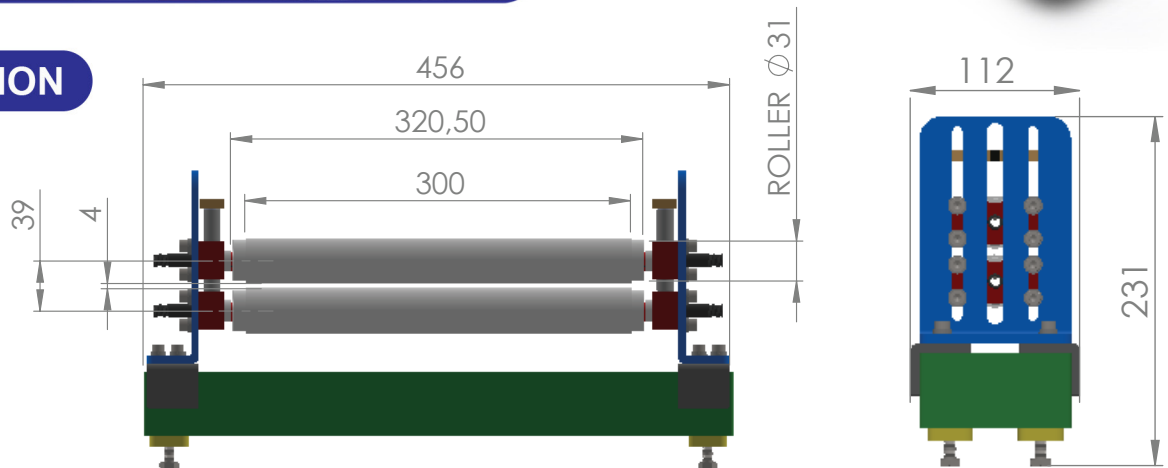

Memo

• The appearance and specifications of all products are subject to change without notice for performance improvement

Manufactured by :



Jl. Beringin No.9, Cibatu, Cikarang Selatan,
Kabupaten Bekasi, Jawa Barat 17530- Indonesia

More Information :



newproject03@daebaek.co.id



021 2918 5124



www.ptdaebaek.com

Address & Location



Plant 2 & Office

Jl. Beringin Plot F12/05 Delta Silicon II
Kawasan Lippo Cikarang, Cibatu, Cikarang
Selatan, Kabupaten Bekasi, Jawa Barat 17530



PT. DAE BAEK